

高精度表面贴装 VC-TCXO/TCXO

DSA211SSA/DSA221SSA/DSA321SSA
DSB211SSA, DSB211SSB/DSB221SSA, DSB221SSB/DSB321SSA, DSB321SSB

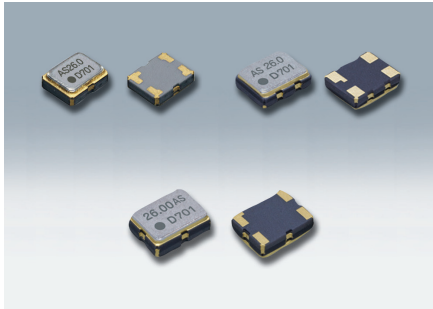

实际尺寸 DSA211SSA □ DSA221SSA □
DSA321SSA □

■ 优点

- 支持低电压
- 低相位噪声
- 单体结构

■ 用途

- 手机、GPS/GNSS、工业用无线通信设备等



[型号]

VC-TCXO	TCXO	带Stand-by功能TCXO	尺寸
DSA211SSA	DSB211SSA	DSB211SSB	2016尺寸
DSA221SSA	DSB221SSA	DSB221SSB	2520尺寸
DSA321SSA	DSB321SSA	DSB321SSB	3225尺寸

■ 一般规格

项目	VC-TCXO			TCXO					
	DSA211SSA	DSA221SSA	DSA321SSA	DSB211SSA	DSB221SSA	DSB321SSA	DSB211SSB (带Stand-by功能)	DSB221SSB (带Stand-by功能)	DSB321SSB (带Stand-by功能)
输出频率范围	12.288~52MHz	10~52MHz		12.288~52MHz	10~52MHz			12.288~52MHz	10~52MHz
标准频率	26MHz/38.4MHz/52MHz								
电源电压范围	+1.62~+3.63V								
电源电压 (Vcc)	+1.8V/+2.5V/+2.8V/+3.3V								
消耗电流	+1.8mA max.(f≤20MHz) / +2.2mA max.(20MHz< f)			+1.6mA max.(f≤20MHz) /+2.2mA max.(20MHz< f)					
待机时电流 (# 1引脚"L")	-						+2μA max.		
输出电压	0.8Vp-p min. (f≤52MHz) (削峰正弦波/DC-coupled)								
输出负载	10kΩ//10pF								
频率稳定度 常温偏差	±1.5×10 ⁻⁶ max. (After 2 reflows)								
温度特性	±2.0×10 ⁻⁶ max./-30~+85°C ±2.0×10 ⁻⁶ max./-40~+85°C (Option)								
电源电压特性	±0.2×10 ⁻⁶ max. (Vcc ±5%)								
负载变化特性	±0.2×10 ⁻⁶ max. (10kΩ//10pF±10%)								
长期老化	±1.0×10 ⁻⁶ max./year								
频率控制 控制灵敏度	±3.0×10 ⁻⁶ ~±5.0×10 ⁻⁶ /Vcont=+1.4V±1V @Vcc≥+2.6V ±3.0×10 ⁻⁶ ~±5.0×10 ⁻⁶ /Vcont=+0.9V±0.6V @Vcc=+1.8V			-					
频率控制极性	正极性			-					
启动时间	2.0ms max.								
输出使能时间	-						2.0ms max.		
相位噪声	[f≤15MHz]			[15MHz<f≤26MHz]			[26MHz<f≤52MHz]		
Offset 100Hz	-115dBc/Hz			-110dBc/Hz			-105dBc/Hz		
Offset 1kHz	-135dBc/Hz			-130dBc/Hz			-125dBc/Hz		
Offset 10kHz	-150dBc/Hz			-150dBc/Hz			-145dBc/Hz		
Offset 100kHz	-155dBc/Hz			-155dBc/Hz			-150dBc/Hz		
包装单位 (1)	DSA211SSA/DSA221SSA, DSB211SSA, DSB211SSB/DSB221SSA, DSB221SSB: 3000pcs./reel(φ180) DSA321SSA, DSB321SSA, DSB321SSB: 2000pcs./reel(φ180)								

(1) 无需防湿包装管理
Moisture Sensitivity Level: LEVEL1 (IPC/JEDEC J-STD-033)

有关其他规格或者特殊规格请咨询营业部门。

高精度表面贴装 VC-TCXO/TCXO

For Mobile communications/Industrial system/GPS/GNSS

外形尺寸

[mm]

■ DSA211SSA/DSB211SSA/DSB211SSB

型号代码
AS : VC-TCXO (DSA211SSA)
BS : TCXO (DSB211SSA)
CS : TCXO (DSB211SSB 带Stand-by功能)

Pin Connections	
Pin No.	Connection
#1	Vcont(VC-TCXO)/GND(TCXO) ENABLE/DISABLE (Stand-by Function)
#2	GND
#3	Output
#4	Vcc

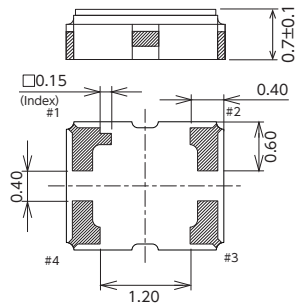
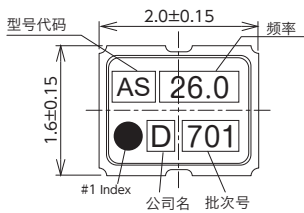

■ 焊盘图形 (参考) <Top View>

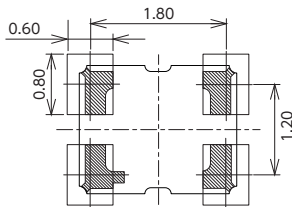

■ DSA221SSA/DSB221SSA/DSB221SSB

型号代码
AS : VC-TCXO (DSA221SSA)
BS : TCXO (DSB221SSA)
CS : TCXO (DSB221SSB 带Stand-by功能)

Pin Connections	
Pin No.	Connection
#1	Vcont(VC-TCXO)/GND(TCXO) ENABLE/DISABLE (Stand-by Function)
#2	GND
#3	Output
#4	Vcc

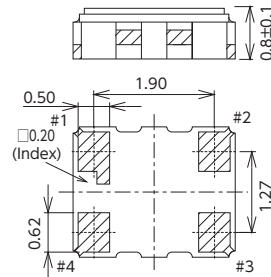
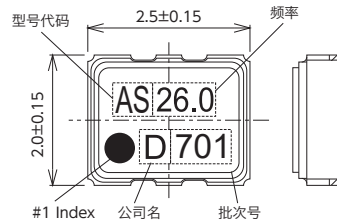

■ 焊盘图形 (参考) <Top View>

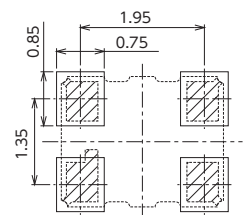

■ DSA321SSA/DSB321SSA/DSB321SSB

型号代码
AS : VC-TCXO (DSA321SSA)
BS : TCXO (DSB321SSA)
CS : TCXO (DSB321SSB 带Stand-by功能)

Pin Connections	
Pin No.	Connection
#1	Vcont(VC-TCXO)/GND(TCXO) ENABLE/DISABLE (Stand-by Function)
#2	GND
#3	Output
#4	Vcc

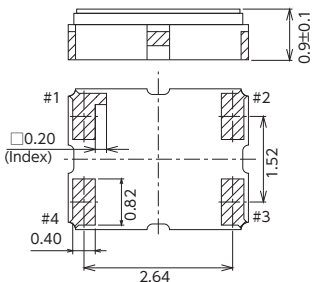
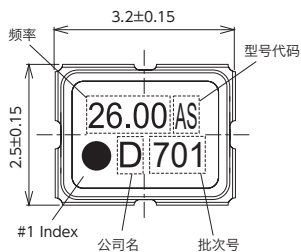

■ 焊盘图形 (参考) <Top View>

