

# Emboss Carrier Tape (SMD Crystal Resonators)

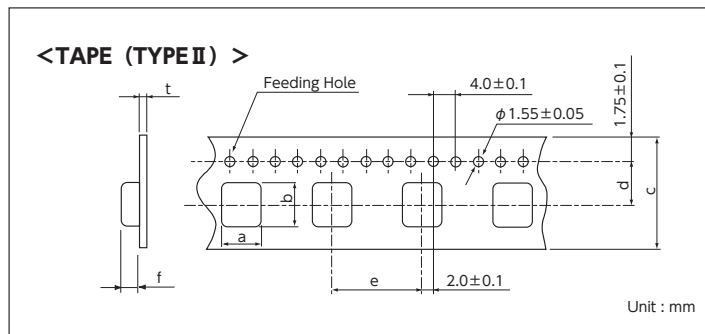
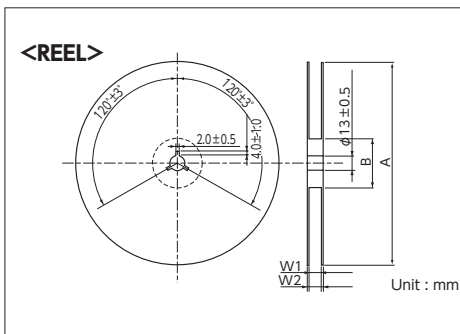
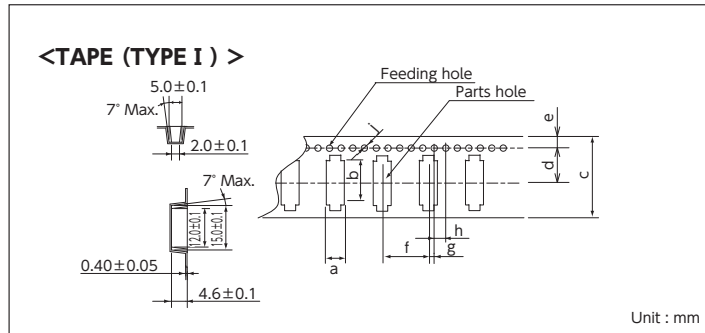
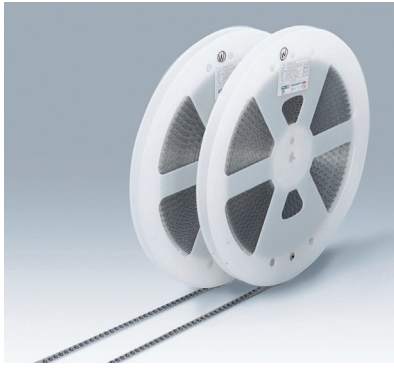

## Standard Specification

MHz Band Crystal Resonators / Crystal Resonators with dedicated temperature sensor

TYPE II	a	b	c	d	e	f	t	A	B	W1	W2
DSX530GA/GK	3.6 ±0.1	5.45 ±0.10	12.0 ±0.2	5.50 ±0.10	8.0 ±0.1	1.55 ±0.10	0.30 ±0.05	φ180 +0/-3	φ60 +1.0/-0	13.0 ±0.3	15.4 ±1.0
DSX321G/GK DSX320GE	2.8 ±0.1	3.5 ±0.1	8.0 ±0.2	3.50 ±0.05	4.0 ±0.1	1.0 ±0.1	0.25 ±0.05	φ180 +0/-3	φ60 +1/-0	9.0 ±0.3	11.4 ±1.0
DSX321SH	2.7 ±0.1	3.4 ±0.1	8.0 ±0.2	3.50 ±0.05	4.0 ±0.1	1.4 ±0.1	0.25 ±0.05	φ180 +0/-3	φ60.0 +1/-0	9.0 ±0.3	11.4 ±1.0
DSX221SH	2.25 ±0.1	2.7 ±0.1	8.0 ±0.2	3.50 ±0.05	4.0 ±0.1	0.8 ±0.05	0.25 ±0.05	φ180 +0/-3	φ60.0 +1/-0	9.0 ±0.3	11.4 ±1.0
DSX211S/SH	1.9 ±0.1	2.3 ±0.1	8.0 ±0.2	3.50 ±0.05	4.0 ±0.1	0.65 ±0.10	0.25 ±0.05	φ180 +0/-3	φ60.0 +1/-0	9.0 ±0.3	11.4 ±1.0
DSX211G	1.85 ±0.10	2.25 ±0.10	8.0 ±0.2	3.50 ±0.05	4.0 ±0.1	0.95 ±0.10	0.25 ±0.05	φ180 +0/-3	φ60 +1/-0	9.0 ±0.3	11.4 ±1.0
DSX210GE	2.0 ±0.1	2.4 ±0.1	8.0 ±0.2	3.50 ±0.05	4.0 ±0.1	0.95 ±0.1	0.25 ±0.05	φ180 +0/-3	φ60 +1/-0	9.0 ±0.3	11.4 ±1.0
DSX1612S	1.45 ±0.15	1.85 ±0.15	8.0 ±0.2	3.50 ±0.05	4.0 ±0.1	0.45 ±0.15	0.25 ±0.05	φ180 +0/-3	φ60 +1/-0	9.0 ±0.3	11.4 ±1.0
DSX1210A	1.17 ±0.05	1.42 ±0.05	8.0 +0.3/-0.1	3.50 ±0.05	4.0 ±0.1	0.48 ±0.05	0.20 ±0.05	φ180 +0/-3	φ60 +1/-0	9.0 ±0.3	11.4 ±1.0
DX1008JS/JT	1.0 ±0.05	1.2 ±0.05	8.0 ±0.2	3.50 ±0.05	4.0 ±0.1	0.45 ±0.05	0.20 ±0.05	φ180 +0/-3	φ60 +1/-0	9.0 ±0.3	11.4 ±1.0
DSR221STH	2.25 ±0.1	2.7 ±0.1	8.0 ±0.2	3.50 ±0.05	4.0 ±0.1	1.15 ±0.10	0.25 ±0.05	φ180 +0/-3	φ60 +1/-0	9.0 ±0.3	11.4 ±1.0
DSR211STH	1.9 ±0.1	2.3 ±0.1	8.0 ±0.2	3.50 ±0.05	4.0 ±0.1	0.85 ±0.10	0.25 ±0.05	φ180 +0/-3	φ60 +1/-0	9.0 ±0.3	11.4 ±1.0
DSR1612ATH	1.40 ±0.1	1.80 ±0.1	8.0 ±0.2	3.50 ±0.05	4.0 ±0.1	0.70 ±0.10	0.25 ±0.05	φ180 +0/-3	φ60 +1/-0	9.0 ±0.3	11.4 ±1.0
DSR1210ATH	1.3 ±0.1	1.5 ±0.1	8.0 ±0.2	3.5 ±0.05	4.0 ±0.1	0.65 ±0.01	0.25 ±0.05	φ180 +0/-3	φ60 +1/-0	9.0 ±0.3	11.4 ±1.0

kHz Band Crystal Resonators

DST310SA	1.70 ±0.05	3.40 ±0.05	12.0 ±0.2	5.50 ±0.05	4.0 ±0.1	0.95 ±0.05	0.25 ±0.05	φ180 +0/-3	φ60 +1/-0	13.0 ±0.3	15.5 ±1.0
DST210AC	1.45 ±0.1	2.3 ±0.1	8.0 ±0.2	3.50 ±0.05	4.0 ±0.1	0.65 ±0.10	0.20 ±0.05	φ180 +0/-3	φ60 +1/-0	9.0 ±0.3	11.4 ±1.0
DST1610A	1.28 ±0.05	1.79 ±0.05	8.0 +0.3/-0.1	3.50 ±0.05	4.0 ±0.1	0.65 ±0.10	0.20 ±0.05	φ180 +0/-3	φ60 +1/-0	9.0 ±0.3	11.4 ±1.0
DST1210A	1.17 ±0.05	1.42 ±0.05	8.0 +0.3/-0.1	3.50 ±0.05	4.0 ±0.1	0.48 ±0.05	0.20 ±0.05	φ180 +0/-3	φ60 +1/-0	9.0 ±0.3	11.4 ±1.0

※1: To indicate product name and other information, place those information on a label, and affix the label on one side of the flange.

2: For DSX321G, DSX1612S pin No.1 is located on the sprocket-hole side of the tape.

3: For other models, the insertion direction is not specified.